

GB Instruction for use

POWERTEX

Sling Hook SHR



User Manual

POWERTEX Sling Hook SHR

Assembly / Instruction for use (GB) (Original instructions)

Failure to follow this user instruction may cause serious consequences such as risk of injury.
Read and understand these instructions before use.

General description

POWERTEX Sling hook for round slings SHR is developed to be used as a temporary connection between EN1492-2 round slings and the load. The hook is designed to facilitate connection of the round sling to the load's lifting point and to protect the round sling from being cut or damaged. The hook is not intended to be permanently installed to the sling but as a temporary lifting tool. For permanent installations we recommend the use of a suitable shackle or similar. POWERTEX SHR hooks meet the relevant requirements of EN 1677-2, EN 1492-2, the Machinery Directive 2006/42/EC and UK Supply of Machinery (Safety) Regulations 2008 and Section 6 of the Health and Safety at Work Etc. Act 1974.

Material: Forged alloy steel.

Finish: Powder painted in the same color as the corresponding POWERTEX PRS round sling having same WLL.

Proof load testing: Each product is crack detection tested in the factory prior delivery and samples are proof load tested to 2,5 x WLL.

Temperature SHR hooks: -40°C up to +200°C (without reduction in WLL).

Temperature range PRS polyester round slings: -40°C up to +100°C.

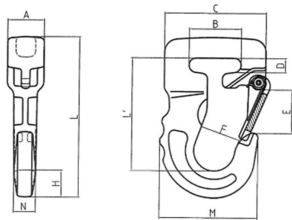

Data

Model	WLL (ton)	For round sling size	A	B	C	D	M (mm)	E	F	L	L'	H	N	Weight (kg)
SHR-1T-10	1	1 t	28	40	78	11	75,7	32	31	124	87	21	17	0,7
SHR-2T-10	2	2 t	35	44,5	91	12,5	90	40	39	148	103	27	21	1,3
SHR-3T-10	3	3 t	45	54	113	15,5	110	40	47	175	115	33	26	2,3
SHR-5T-10	5	5 t	56	76,5	133	21	139	50	60	223	147	40,5	32	4,6

Safety factor: 4:1

Marking

POWERTEX SHR hooks are marked with:

- Working Load Limit e.g. WLL 1T
- Steel grade e.g. Grade 10
- Manufacturer's symbol e.g. POWERTEX
- Model e.g. SHR-1T-10
- Forging batch code e.g. AB3
- CE and UKCA conformity marks

Instruction before use

Select the correct size of hook having WLL which matches the WLL of the round sling.

Check that the round sling and the hook are both free from defects such as wear, cuts, nicks, gauges, cracks, deformations or any other harmful damages.

Check that all markings are legible, and that the hook's safety latch is in good condition.

Assembly

Insert the round sling through the opening of the hook and slide it into the top seating of the hook where the round sling should seat properly in the round sling connection. Make sure that the round sling fits well in the seated position without being squeezed or blocked. Check that the sling has not been twisted during the assembly. If the sling does not fit well check if the hook size corresponds to the round sling size. Potentially different brands of round slings could vary in cross section and width depending on the strength of fiber being used.

Instruction for use

Lift smoothly and straight through the hook's centerline as side loading or point loading is not allowed. When using hooks and roundslings as multi-leg slings, due consideration should be given to the effect of the angle between the sling legs. As the angle increases so does the load in the sling and consequently in any hook attached to the sling leg. Check the WLL chart from the sling manufacturer. Do not use hooks outside the permitted temperature range of -40°C to +200°C without consulting the manufacturer.

Grade 10 hooks should not be immersed in acidic solutions or exposed to acid fumes or other chemicals without the approval of the manufacturer. Attention to be drawn to the fact that certain production processes involve acidic solutions, fumes etc. and in these circumstances the manufacturer's advice should be sought. The rating of the hooks assumes the absence of exceptionally hazardous conditions. Exceptionally hazardous conditions include offshore activities, the lifting of persons and lifting of potentially dangerous loads such as molten metals, corrosive materials or fissile materials. In such cases the degree of hazard should be assessed by a competent person and the safe working load reduced accordingly from the working load limit.

Inspection

The hook must be visually inspected before each use and must undergo a thorough inspection at least every 12 months. Please note local rules and regulations must be complied with in regards to inspection.

Check that marking is legible and that latch is in good condition. Check there are no cuts, nicks, gauges, cracks, deformations, corrosion or other harmful damages such as overheating. Wear must not exceed 10% of initial dimensions. Replace latch or hook if damages could be detected.

Disclaimer

We reserve the right to modify product design, materials, specifications or instructions without prior notice and without obligation to others. If the product is modified in any way, or if it is combined with a non-compatible product/component, we take no responsibility for the consequences in regard to the safety of the product.

End of use/Disposal

POWERTEX Grade 10 hooks shall be sorted/scrapped general steel scrap.

Your POWERTEX distributor will assist you with the disposal, if required.

EC Declaration of conformity

SCM Citra OY

Asessorinkatu 3-7

20780 Kaarina Finland

www.powertex-products.com

hereby declares that POWERTEX product as described above is in compliance with EC Machinery Directive 2006/42/EC.

UK Declaration of conformity

SCM Citra OY

Asessorinkatu 3-7

20780 Kaarina, Finland

www.powertex-products.com

hereby declares that the POWERTEX product as described above is in compliance with the Supply of Machinery (Safety) Regulations 2008.

CertMax+

The CertMax+ system is a unique leading edge certification management system which is ideal for managing a single asset or large equipment portfolio across multiple sites. Designed by the Lifting Solutions Group, to deliver optimum asset integrity, quality assurance and traceability, the system also improves safety and risk management levels.

CertMax

Marking

The POWERTEX Sling Hook SHR is **CE** and **UKCA** marked.

Standard: Relevant requirements of EN 1677-2 and EN 1492-2.



User Manuals

You can always find the valid and updated User Manuals on the web. The manual is updated continuously and valid only in the latest version.

NB! The English version is the Original instruction.

The manual is available as a download under the following link:
www.powertex-products.com/manuals



Product compliance and conformity

SCM Citra OY
Asessorinkatu 3-7
20780 Kaarina
Finland
www.powertex-products.com



POWERTEX

www.powertex-products.com